

RECORD DRAWINGS

AS-BUILT DRAWING
THIS DRAWING IS FOR AS-BUILT
INFORMATION ONLY.

AS-BUILT
INFORMATION
FURNISHED BY: DOYLE
LAND SURVEYING

MAY 13, 2011 AND
OCTOBER 12, 2012

DRAWING NOT FOR
CONSTRUCTION

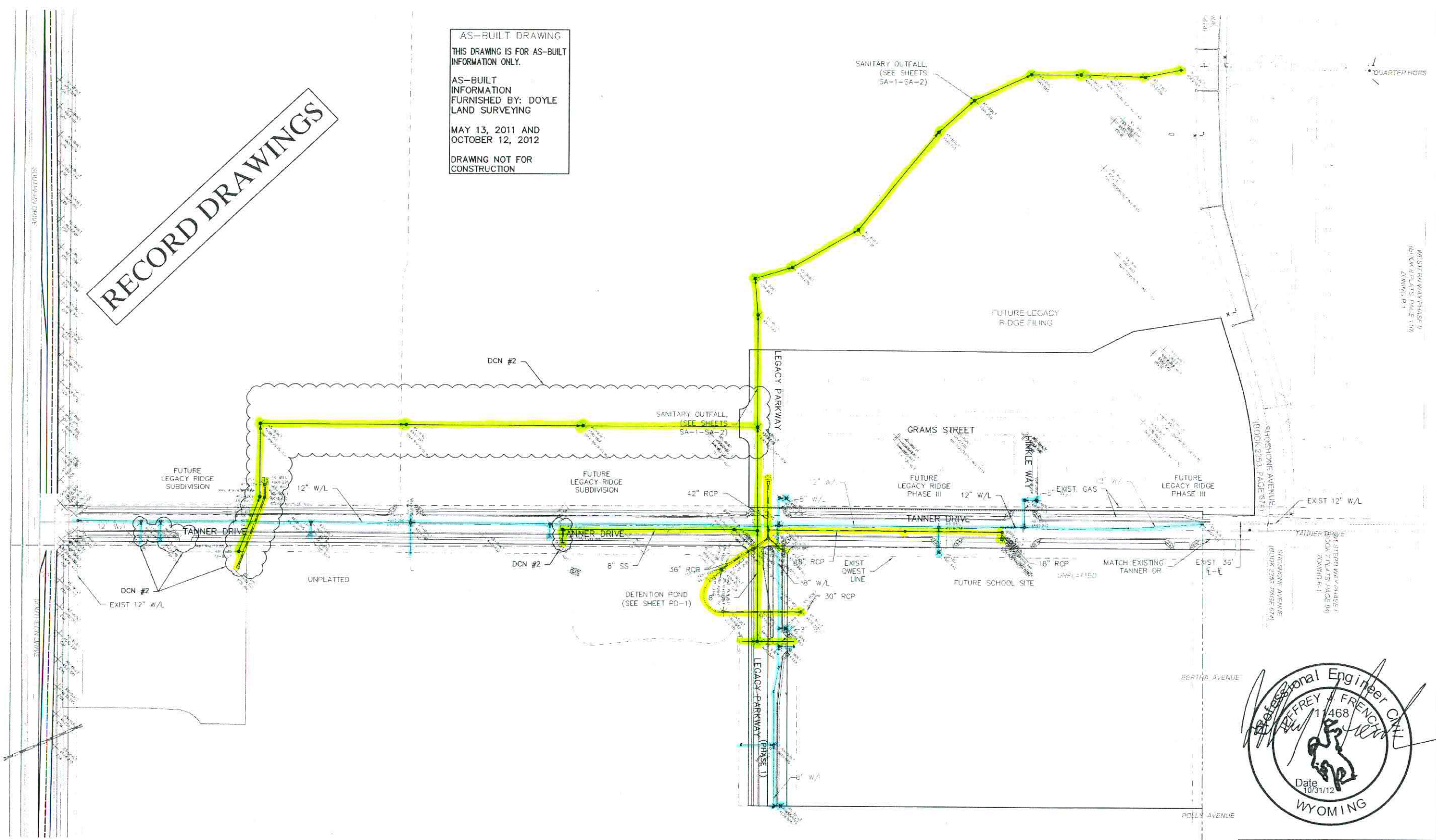

- UTILITY NOTES:**
1. SEE SHEETS WA-1 THROUGH WA-3 FOR CONSTRUCTION DETAIL OF WATERLINE.
 2. SEE SHEET SA-3 FOR CONSTRUCTION DETAIL OF SANITARY SEWER.
 3. CONTRACTOR TO REMOVE AND REPLACE EXISTING CURB, GUTTER, SIDEWALK AS REQUIRED FOR TANNER DRIVE SERVICE LINE IMPROVEMENTS.
 4. CONTRACTOR TO FIELD VERIFY ALL EXISTING UTILITIES PRIOR TO CONSTRUCTION, INCLUDING BUT NOT LIMITED TO GAS, WATER LINES, SANITARY SEWER, ETC.

- PHASING NOTES:**
1. WATERLINES SHALL BE TEMPORARILY DEAD-ENDED WITH A VALVE, TEMPORARY PLUG, BLOW-OFF, AND THRUST BLOCK AT FUTURE PHASE LINES. SANITARY SEWER MAINS SHALL BE CONSTRUCTED TO THE NEXT MANHOLE WITHIN THE FUTURE PHASE. STREETS SHALL BE ENDED AT PHASE LINE OR PCR AND A TEMPORARY TYPE III BARRICADE INSTALLED. STORM SEWER SHALL BE TEMPORARILY PLUGGED AT PHASE LINE.
 2. REFER TO SHEETS SA-3, WA-1 & WA-3 FOR INDIVIDUAL UTILITY INFORMATION.

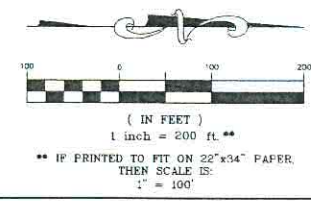

CALL BEFORE YOU DIG
ONE-CALL
OF WYOMING
1-800-849-2476
UTILITY NOTIFICATION CENTER OF WYOMING

BENCHMARK:
CITY OF GILLETTE, WCM #36 AT THE END OF PAVEMENT ON THE WEST END OF SHOSHONE AT TANNER LOCATED AT 136819.3N 589050E, ELEV 4622.555.

NO.	REVISION	DATE	BY
4	DESIGN CHANGE NOTICE #1	10/25/10	BK
5	INTERIM AS-BUILT	05/13/11	ML
6	DESIGN CHANGE NOTICE #2	04/18/12	BK
7	DESIGN CHANGE NOTICE #3	06/21/12	BK
8	RECORD DRAWINGS	10/31/12	BK

TANNER DRIVE & LEGACY PARKWAY PLANS

OVERALL PLAN

DEVELOPER:
THE MC FAMILY OF COMPANIES, LLC
P.O. BOX 1269
GILLETTE, WY 82717

(307) 685-1295
(307) 685-8129 FAX
MARK A. CHRISTENSEN

Peak
Civil Consultants
200 W. HAMPDEN AVE., SUITE 200
ENGLEWOOD, COLORADO 80110
PH: 720.855.3850
FAX: 720.855.3860
CONTACT: JEFF FRENCH

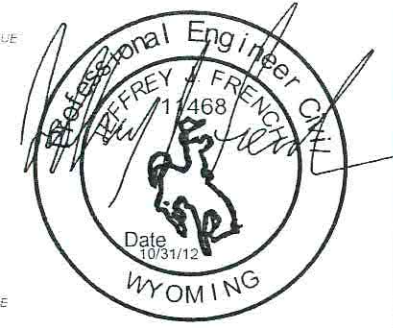

DATE: 02/09/09
JOB NO: 07.39
DRAWN BY: KJK
APPROVED:
CADD FILE:

OA-1
Sheet 2 of 27