

Aerial Map

Project Area

10B

E Collins Rd



CITY OF GILLETTE

GIS Division
P.O. Box 3003
Gillette, Wyoming 82717-3003
Phone (307) 686-5364
www.gillettewy.gov

Vicinity Map

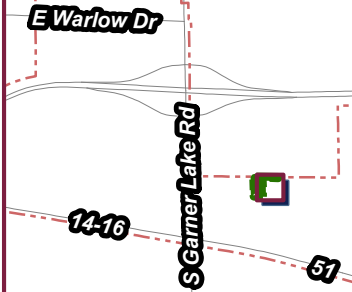

- Projects
- Parcels
- Easements

THE INFORMATION ON THIS DRAWING WAS OBTAINED FROM RECORD AND DESIGN DRAWINGS. THE CITY OF GILLETTE MAKES NO GUARANTEE REGARDING THE ACCURACY OF THIS DRAWING OR THE INFORMATION CONTAINED THEREIN.

Y:\GIS Work\EDS\Planning\PlanningCommissionMaps\13.008V



13.008V - Easement Vacation
for Lot 10B at
Collins Heights Industrial Park

May 7, 2013

Productivity Service With P.R.I.D.E. Enthusiasm
Responsibility Integrity Dedication