

Powder River Shrine Circus – April 16, 2014
Contract #6919 Attachment (page 1 of 2)

Customer
Copy

User (Shriner's) Responsibility:

- Clean-up:** Pick up trash between performances. User shall pay CAM-PLEX for the following:
- a) Hire a cleaning crew to clean the mezzanine bleachers after the final performance to include picking up trash, sweeping and mopping. Rate \$400
 - b) Pay Cam-Plex for extra cleaning on main floor after the final performance to pickup trash, sweep and mop bleachers. Rate \$50
 - c) Cam-plex will designate two employees to mop up snow cone spills after each performance to avoid long term staining. No charge.
- Ticket Sales:** User responsible for pre-sales and door-sales.
- Tractor:** Verify tractor is in good condition and does not leak fluids as user responsible for cleanup expense and damages. Shriner's will provide the concrete tie-downs and move with tractor.
- City Permits** Obtain appropriate authorization for the carnival and wild animals permits.

Jordan's Circus Responsibility:

Concessions: Jordan's responsible for concession & coordinating with WY Beverage for pepsi products. Jordan's cannot sell gum or sunflower seeds, but can sell popcorn. Jordan's responsible for *cleaning the concession room and contacting staff for an inspection prior to departure.*

Equipment: Jordan's responsible for providing ring barriers.

North Loadout – if animals in this area during day...need to protect walls with plastic

ANIMALS IN WYOMING CENTER OVERNIGHT...needs Prior Authorization

If the Circus requests animals be indoors due to the cold weather, the Operations Manager must authorize this in advance, and the following conditions will apply:

- Elephants or other approved animals allowed in North Load out;
- Miniature horses can be in North walkway;
- Other animal needs and locations will be discussed and authorized in advance.

- Circus must provide heavy duty plastic on walls
- One Circus employee can stay in building overnight (on cot with animals)
 - No other persons can be in the building.
 - Elephants will be shackled
 - May need additional dumpster in North Lobby for animal waste
 - No other access in building besides authorized circus employee

CAM-PLEX will:

- Need Circus employee's name and cell phone number
- Will give circus employee our staff contact name & cell phone (Maintenance Staff on Call)
- Notify City Police Department of overnight authorization
- Notify all CAM-PLEX staff for safety and access reasons.

POWDER RIVER SHINE CIRCUS

Contract #6919 Attachment (page 2 of 2)

SCHEDULE & RATES:

April 15, 2014: Cam-Plex Setup Day \$466.50

2 pm – 8 pm: Circus Semi's & campers arrive

And park outside North of Wy Center

**4 pm – 8 pm: Circus may load into hall ONLY & use Locker Rooms>Showers
Lobby & Concession Room remain locked this day.**

Cam-Plex staff will not assist Circus with setup this day.

**Animals not allowed in the building this day (unless otherwise
authorized by Cam-Plex Operations Manager.**

April 16, 2014: EVENT DAY

8 am: In building (using North entrances)
Unlock Shower/Locker Rooms A&B; Conference Rooms B,
And Concession Room 1 (SW Main)

3 pm: Unlock main entrance, Vacuum lobbies if necessary

4 pm Lock Shower Rooms

4 pm FIRST SHOW

7:30 pm SECOND SHOW

9 pm Unlock Shower Rooms

11 pm Lock Shower Rooms

1 am Out of building

Equality Hall \$933

Equality Hall Mezzanine \$587

Equality Hall Conference Room B \$ 67

Equality Hall Concession Room 1 (SW Corner) \$105

Equality Hall Locker Rooms A & B \$ 0

Frontier Hall (1/3 of Comm. Rate) (\$275 x 2 days) \$550

Frontier Hall North Lobby \$ 0

April 17, 2014: Teardown Day (1/2 comm rate EQ H & Mezz) \$760

7 am – 8 pm: Circus remove animals (if overnighted) & Clean

8 am – 9 am User remove loader and concrete tie-downs

9 am – 11 am Remove bleachers

Facilities Rent: 1-20-5540-00 \$3,468.50

____ User

____ CAM-PLEX

April 16, 2014

Bill (702)456-2642

- ### Elephants Holding Area

-

- 2—8' for Merchandise
- All Blinds Up.
- 4 Red Rope Stands
- 2 Ticket Drops
- 4 Turnstiles

WYOMING CENTER at CAM-PLEX

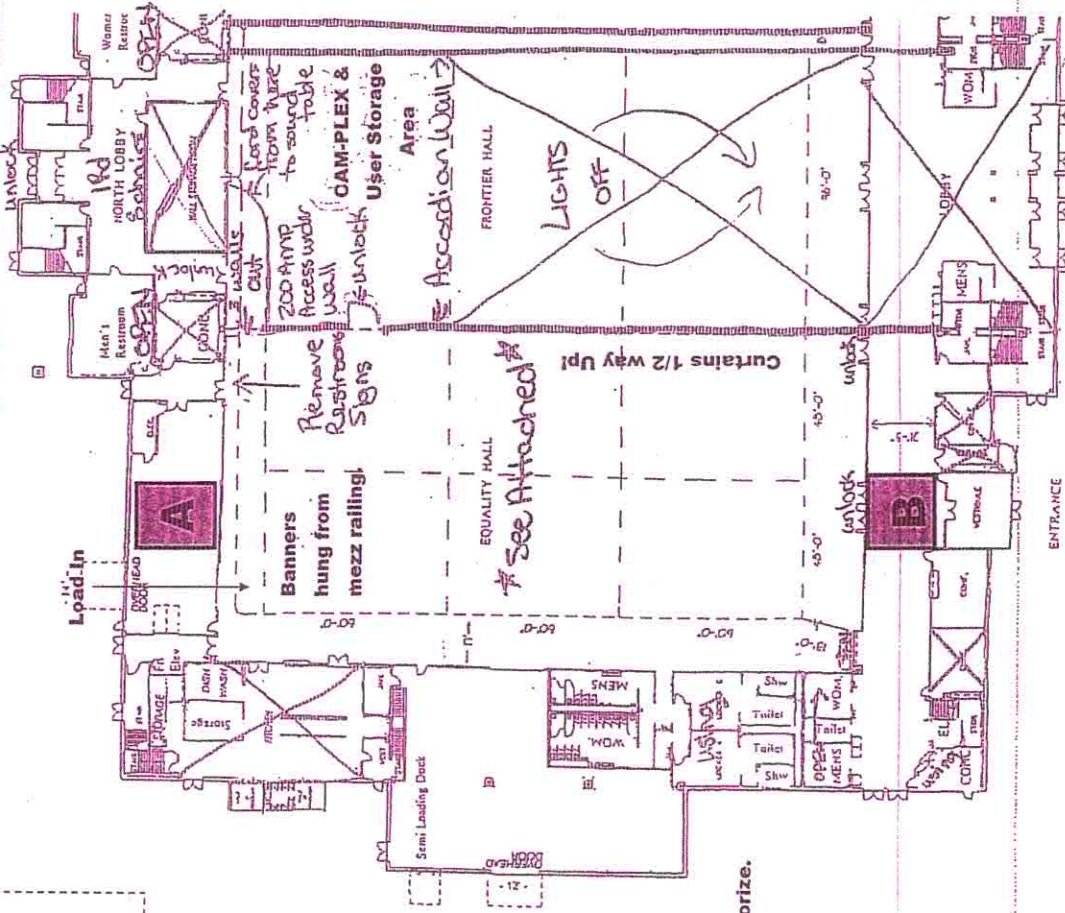

S:Everyone/Shelley/Contract Setups/2014 Shrine Circus

Shrine Circus
April 16, 2014

Mezzanine Setup

- Shrine Club Volunteers will clean bleachers after first performance on both levels.
- CAM-PLEX will hire crew to pick up trash and mop mezzanine. Crew needs to clean North end first.
- CAM-PLEX will pick up trash on main floor after second performance.

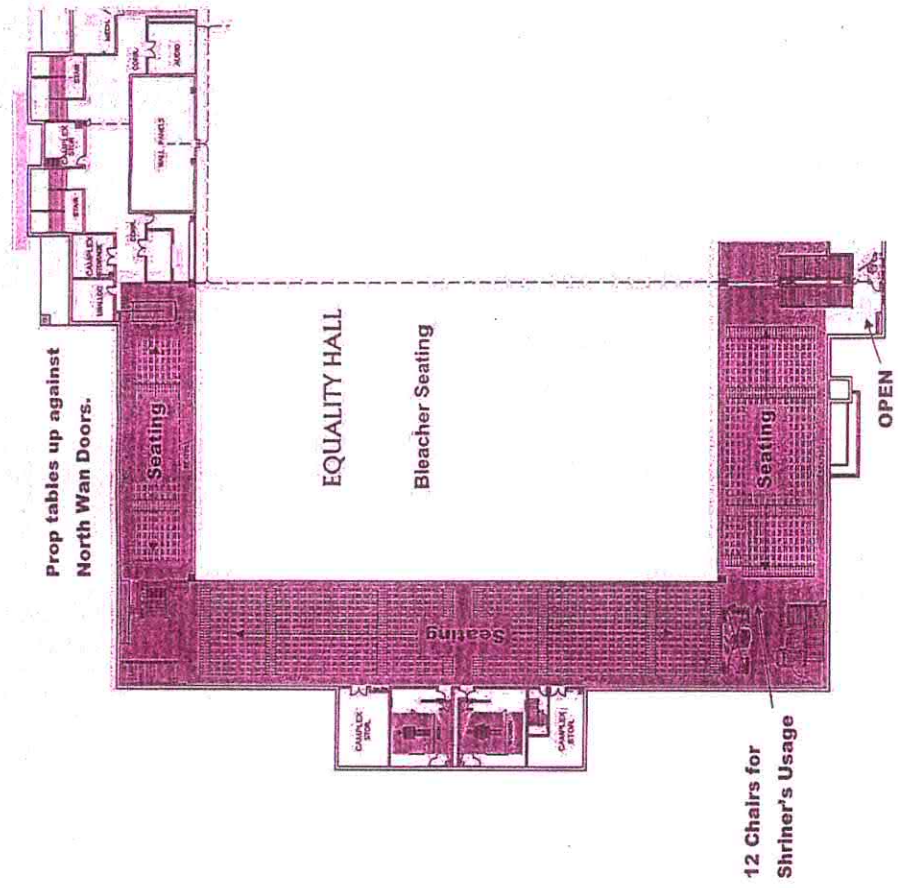

Outside Setup Needs

- Campers & Semi parking is on the North and Northwest corner outside of the WC-EQ.
- Campers and Semi will use Northwest electricity including the 50 Amp (FY1 -2013 Outside Electricity: 7-50 Amp, 11-20 Amp).
- 6 Green Dumpsters set in the south end of Central's West Parking Lot for animal waste. (More may need to be set outside North end of EQ if cold.)
- 4 Dumpsters on West side of WC.
- Extra port-a-pot in Plaza (if available).
- Turn water picket on N end of WC.
- 20 Barricades available on North end of WC, 4 on South end of WC, and 2 on East side of WC by Kitchen.