



# DESIGN DRAWINGS FOR: ALLEY PMS 2016

CITY PROJECT NO. 16EN13

**OWNER:**

CITY OF GILLETTE  
P.O. BOX 3003  
201 E. 5TH STREET  
GILLETTE, WYOMING  
PHONE # 307-686-5265  
FAX # 307-686-0952

**ENGINEER:**

**BRUCE ENGINEERING, INC.**

P.O. Box 2284  
GILLETTE, WY 82716

(307) 686-2252 www.bruce-engineering.com  
CIVIL ENGINEERING • LAND SURVEYING • MANAGEMENT

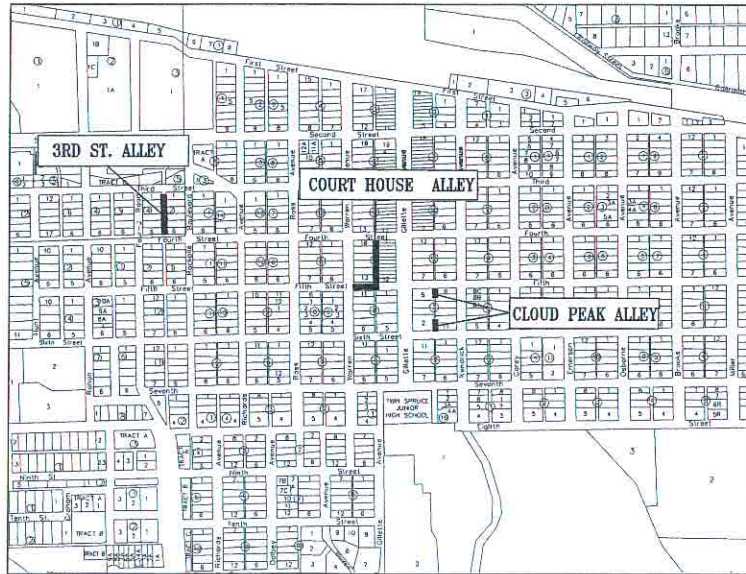

VICINITY MAP  
REA

SHEET NO.	SHEET TITLE
CS-1	COVER SHEET
QS-1/SP-1	QUANTITY SHEET/
SP-1/NL-1	SPECIAL PROVISION
TR-1	COURT HOUSE ALL
TR-2	CLOUD PEAK ALLE
TR-3	3RD STREET ALLEY
SA-1	3RD STREET ALLEY
SA-2	3RD STREET ALLEY
DT-1	GENERAL DETAILS
DT-2	GENERAL DETAILS
DT-3	GENERAL DETAILS
DT-4	GENERAL DETAILS
DT-5	GENERAL DETAILS
DT-6	GENERAL DETAILS
DT-7	GENERAL DETAILS
DT-8	GENERAL DETAILS
DT-9	GENERAL DETAILS

TOTAL # OF SHEETS = 17

## "COURT HOUSE ALLEY"

BETWEEN GILLETTE AVE. AND WARREN AVE.  
FROM 4TH ST. TO 5TH ST. INCLUDING 5TH ST. TO WARREN AVE

## "CLOUD PEAK ALLEY"

BETWEEN GILLETTE AVE. AND KENDRICK AVE.  
FROM 5TH ST. TO 6TH ST.

## "3RD ST. ALLEY"

BETWEEN ROCKPILE BLVD. AND 4J RD.  
FROM 3RD ST. TO 4TH ST.

AUTHORIZED BY:

Kurt Siebenaler 6946 2/29/16  
CITY ENGINEER P.E. NO. DATE



CALL BEFORE YOU DIG  
ONE-CALL OF  
WYOMING  
1-800-849-2476  
OR  
811  
PROTECT INFRASTRUCTURE. PRESERVE THE FUTURE.