

ANNEXATION PLAT

BUTLER SPAETH ROW ANNEXATION

SITUATED IN THE SE1/4 NW1/4 AND THE SW1/4 NE1/4 OF SECTION 2, T49N, R72W  
OF THE SIXTH P. M., CAMPBELL COUNTY, WYOMING

PROJECT  
SITE

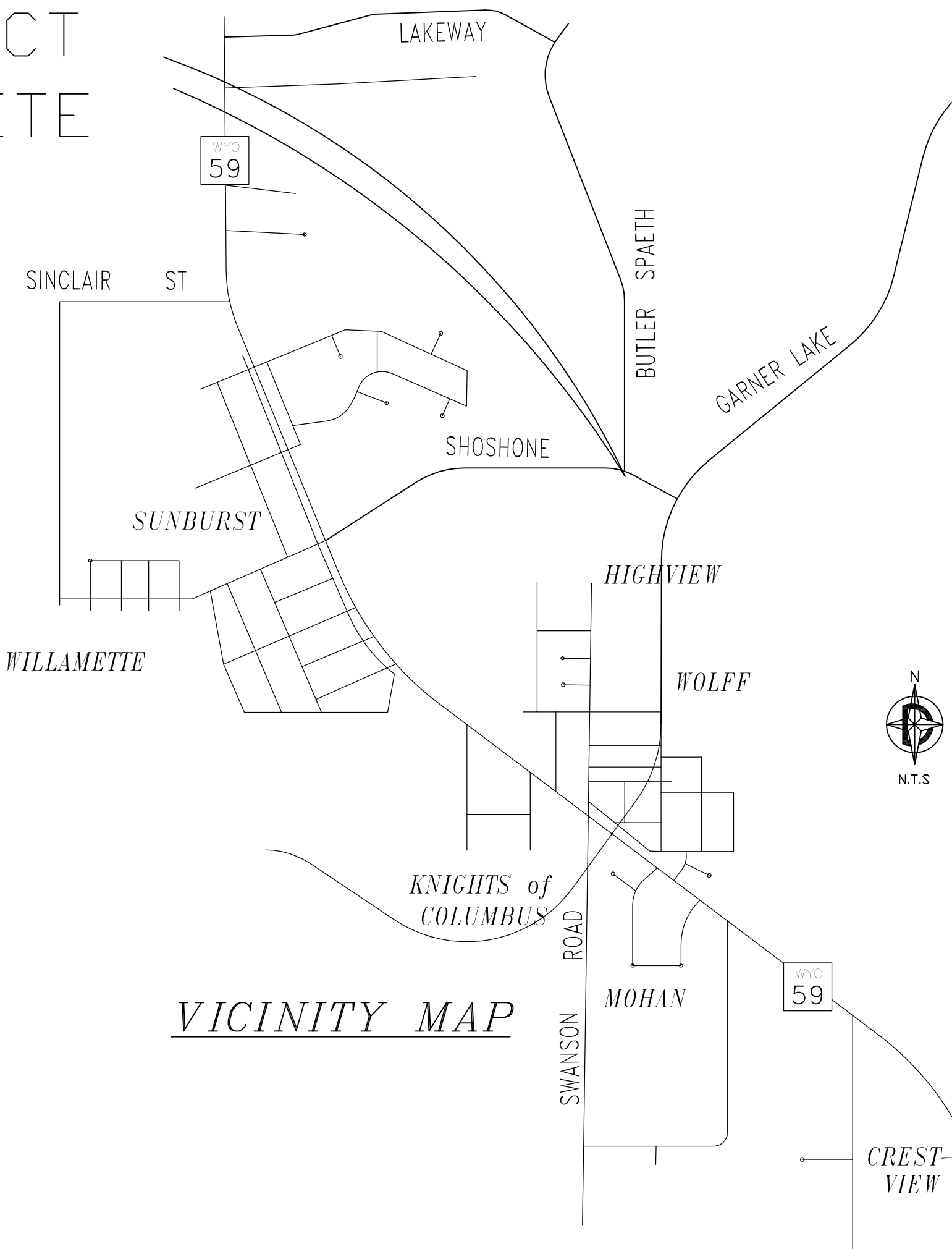

ANNEXATION CERTIFICATE

This Annexation Plat, as it is described and as it appears on this plat, is a true and correct map of the area to be annexed and is made with the desires of the undersigned owner and proprietors and is a correct plat of the area.

Executed this \_\_\_\_ day of \_\_\_\_\_, A.D., 20 \_\_\_\_ by:

Owners:

CITY OF GILLETTE

City of Gillette  
Mayor

Attest

City Clerk

DESCRIPTION

A tract of land being situated in the SE1/4 NW1/4 and the SW1/4 NE1/4 of Section 2, Township 49 North, Range 72 West of the Sixth Principal Meridian, Campbell County, Wyoming. Said tract of land being described more particularly as follows:

Beginning at the Southeast corner of Tract C of Moon Shadow No. 2 First Filing and the Northeast corner of Betcher Annexation at the West right of way of Butler Spaeth Road;  
Thence N89°46'24"E a distance of 100.06 feet to the East right of way of said Butler Spaeth Road;  
Thence S01°42'51"W along the West boundary of the original Edwards Subdivision a distance of 279.12 feet to the Southwest corner of the original Lot 1 of the Edwards Subdivision;  
Thence N89°54'05"E along the South boundary of the said original Lot 1 of the Edwards Subdivision a distance of 30.70 feet to the said East right of way of Butler Spaeth Road;  
Thence Southeasterly along the said East right of way of Butler Spaeth Road along a curve to the left through a central angle of 13°34'21" with a radius of 550.00 feet an arc distance of 130.29 feet and with a chord that bears S24°17'59"E a chord distance of 129.98 feet;  
Thence S58°55'08"W a distance of 100.00 feet to the said West boundary of the Edwards Subdivision and the West right of way of Butler Spaeth Road;  
Thence Northwesterly along the said West right of way of Butler Spaeth Road along a curve to the right through a central angle of 32°51'47" with a radius of 650.00 feet an arc distance of 372.82 feet with a chord that bears N14°39'13"W a chord distance of 367.73 feet;  
Thence N01°42'51"E along the said West right of way of Butler Spaeth Road a distance of 92.91 feet to the POINT OF BEGINNING.

APPROVALS

Data on this plat reviewed this \_\_\_\_ day of \_\_\_\_\_, 20\_\_\_\_, A.D., by the City Engineer of Gillette, Wyoming.

City Engineer

This plat approved by the City of Gillette Planning Commission this \_\_\_\_ day of \_\_\_\_\_, 20\_\_\_\_, A.D.

Chairman

Secretary

Approved by the City Council of the City of Gillette, Wyoming this \_\_\_\_ day of \_\_\_\_\_, 20\_\_\_\_, A.D.

Mayor

City Clerk

SURVEYOR'S CERTIFICATE

I, Richard T. Doyle, do hereby certify that I am a registered land surveyor, licensed under the laws of the State of Wyoming, that this plat is a true, correct, and complete plat of BUTLER SPAETH ROW ANNEXATION, as shown on this Annexation Plat in compliance City of Gillette regulations governing the annexation of the land.



ANNEXATION PLAT

BUTLER SPAETH ROW ANNEXATION  
GILLETTE, WYOMING

Prepared for:  
City of Gillette  
801 E 4TH ST  
Gillette, WY 82717

Prepared by:  
DOYLE SURVEYING INC  
801 E 4TH ST  
Suite 15  
Gillette, WY 82716  
Ph: (307)686-2410

Date of Preparation: OCTOBER, 2016

SHT 1 OF 1

Revised: Nov. 3, 2016

This plat filed for record in the office of the Clerk and Recorder at \_\_\_\_ o'clock \_\_\_\_ m., 20\_\_\_\_, and is duly recorded in Book \_\_\_\_\_, Page No. \_\_\_\_.

County Clerk

SUMMARY

AREA: 0.965 AC  
ZONE: I-1

LEGEND

- FOUND CORNER
- SET CORNER

BENCHMARK: LOCAL CONTROL

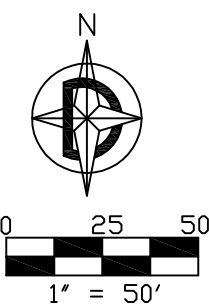

R=650.00  
L=372.82  
D=32°51'47"  
CH=N14°39'13"W 367.73

R=550.00  
L=130.29  
D=13°34'21"  
CH=S24°17'59"E 129.98

DEVON  
ADDITION

LOT 4

LOT 1

0.965  
AC

BETCHER  
ANNEXATION

TRACT C

SHOSHONE AVENUE  
80' ROW

MOON SHADOW 2  
SUBDIVISION  
FIRST FILING

STATE OF WYOMING )  
-----)ss.  
CAMPBELL COUNTY )  
The foregoing instrument was acknowledged before me  
this \_\_\_\_ day of \_\_\_\_\_, A.D., 20\_\_\_\_, by Louise Carter King  
as Mayor of the City of Gillette as a free and voluntary act and deed.

Witness my hand and official seal.

\_\_\_\_\_  
Notary Public  
My Commission Expires: \_\_\_\_\_